



CALIBER 80 SUB

TECHNICAL DATASHEET

PROJECT INFORMATION

Project Name:

Reference:

Quantity:



IP68
MADE IN ITALY

TECHNICAL DRAWING

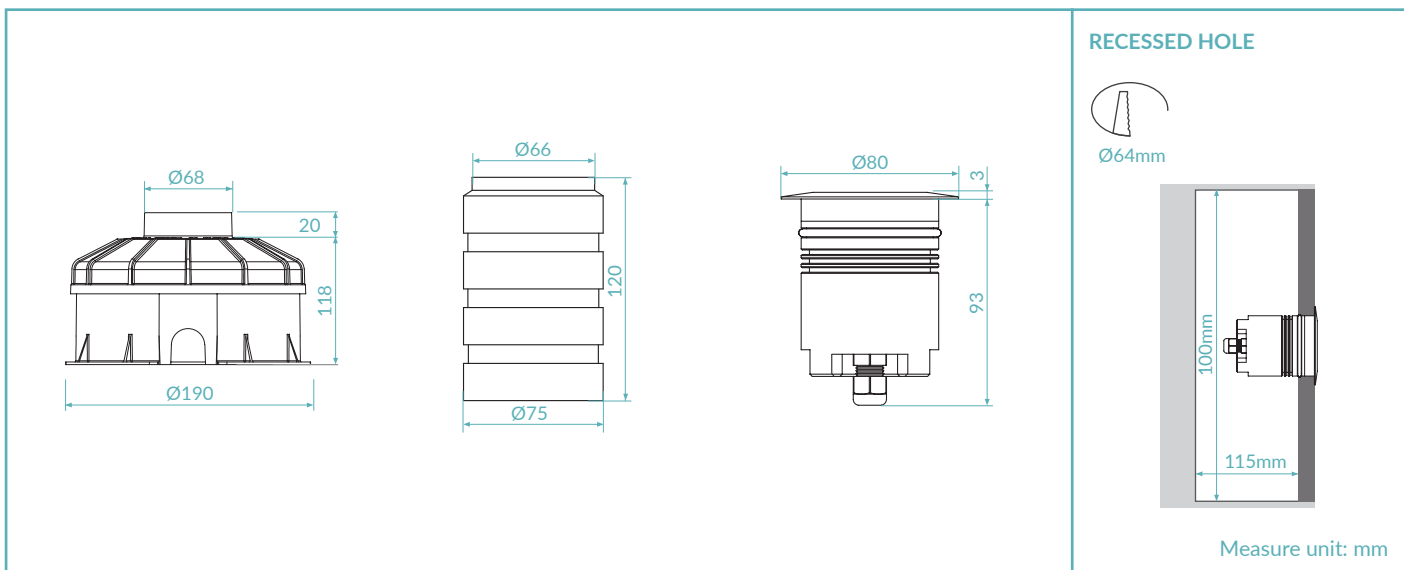

FINISHES



.12
Electropolished
stainless steel AISI316L

PRODUCT CODE

C8S = CALIBER 80 SUB

Select one component from each column to specify a complete configuration:

	LED colour	Optics	Finish	Power
	27 = 2700K 30 = 3000K 40 = 4000K FC = RGBW	N = 10° (10° RGBW) M = 30° (35° RGBW) W = 50° E = 10° x 45° S = Satin	12 = Electropolished stainless steel AISI316L	05 = 5W 09 = 9W CC = 4x700mA RGBW

Standard configuration example:

C8S.30.N.12.09 | Caliber 80 sub 3000K 10°optics electropolished stainless steel 9W

TECHNICAL SHEET

LIGHTING CHARACTERISTICS

Color Rendering Index	CRI > 90
Lumen output (source)	647 lm / 896 lm (3000K)
Lumen output (delivered)	409 lm / 590 lm (3000K)
Optics	10° / 30° / 50° / 10°x 45° / Satin / 10° - 35° RGBW
LED colour temperature	2700K / 3000K / 4000K / RGBW
LED lifetime	50000h L95 B10 (Ta 25°C)
Bin selection	Binning free 2 step MacAdam's

MECHANICAL CHARACTERISTICS

Body	Stainless Steel AISI316L
Glass	Tempered extra clear / frosted glass 8mm
Finishes	Electropolished stainless steel AISI316L
Installation	Housing box
Impact resistance	IK08
Weight	1,1kg

ELECTRICAL CHARACTERISTICS

Power supply	Constant voltage 24Vdc / Constant current 4x700mA RGBW
Power supply cables	500cm NS20N PCP 2x0,5mm ² / 500cm 8x0,22mm ² RGBW
Power consumption	5 Watt / 9 Watt / 9 Watt RGBW
Dimmable	Dimmable

GENERAL CHARACTERISTICS

Operating temperature	-20°C +50°C
IP rating	IP68 (5 meter underwater)
Insulation class	Class III
Photobiological risk	RG0/RG1

ACCESSORIES

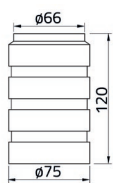

Housing box

Art. Nr.
HB.003

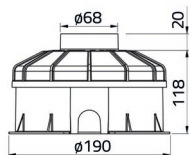

Housing box IP

Art. Nr.
HB.014

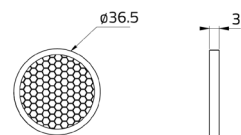

Honeycomb louver

Art. Nr.
ACC.004

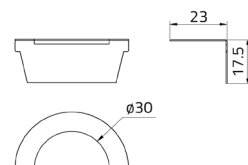

Anti-Glare louver

Art. Nr.
ACC.073

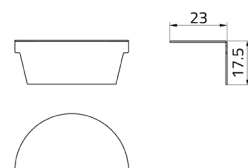

Anti-Glare louver

Art. Nr.
ACC.088

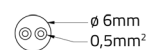

Cable

Art. Nr.
CV00040
CV00041
CV00042
CV00043

Length
10m
15m
20m
25m

POWER SUPPLIES 24Vdc CONSTANT VOLTAGE

On / Off

Code	Input	I Out	V Out	Watt	IP
PSU.CX.004	110÷240V / 50/60 Hz	0,9 A	24Vdc	20	IP20
PSU.CV.005	90÷305V / 47/63 Hz	1 A	24Vdc	25	IP67
PSU.CV.006	90÷305V / 47/63 Hz	2,5 A	24Vdc	60	IP67
PSU.CV.007	90÷305V / 47/63 Hz	3,75 A	24Vdc	90	IP67
PSU.CV.021	90÷305V / 47/63 Hz	10 A	24Vdc	240	IP67

Control Gear

Code	Input	I Out	V Out	Watt	IP
CGE.004 - 0/1-10V	24Vdc	6,5 A	24Vdc	156	IP20
CGE.017 - DALI	24Vdc	6,5 A	24Vdc	156	IP20
CGE.017.IP - DALI	24Vdc	6,5 A	24Vdc	156	IP67
CGE.020 - DMX	24Vdc	6,5 A	24Vdc	156	IP67

Control Gear RGBW

Code	Input	I Out	V Out	Watt	IP
CGE.005 - DMX	024Vdc	4x700mA	24Vdc	67,2	IP20

OPTICS

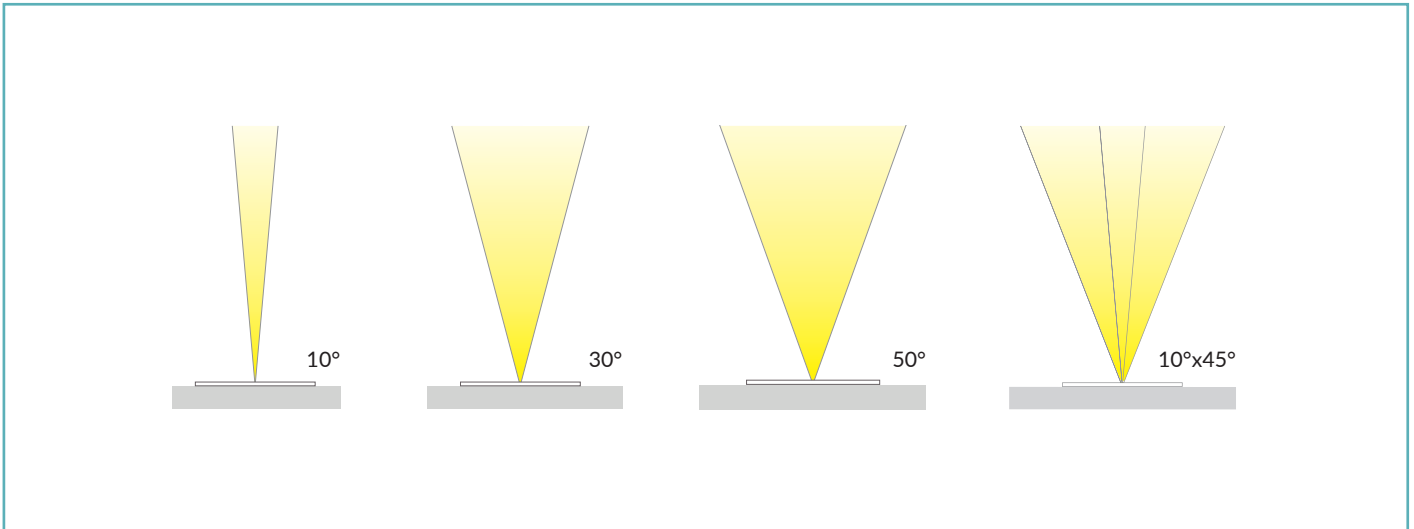

PHOTOMETRICS

