



AGILE 60 - GU10

TECHNICAL DATASHEET

PROJECT INFORMATION

Project Name:

Reference:

Quantity:



CE IP66
MADE IN ITALY

TECHNICAL DRAWING

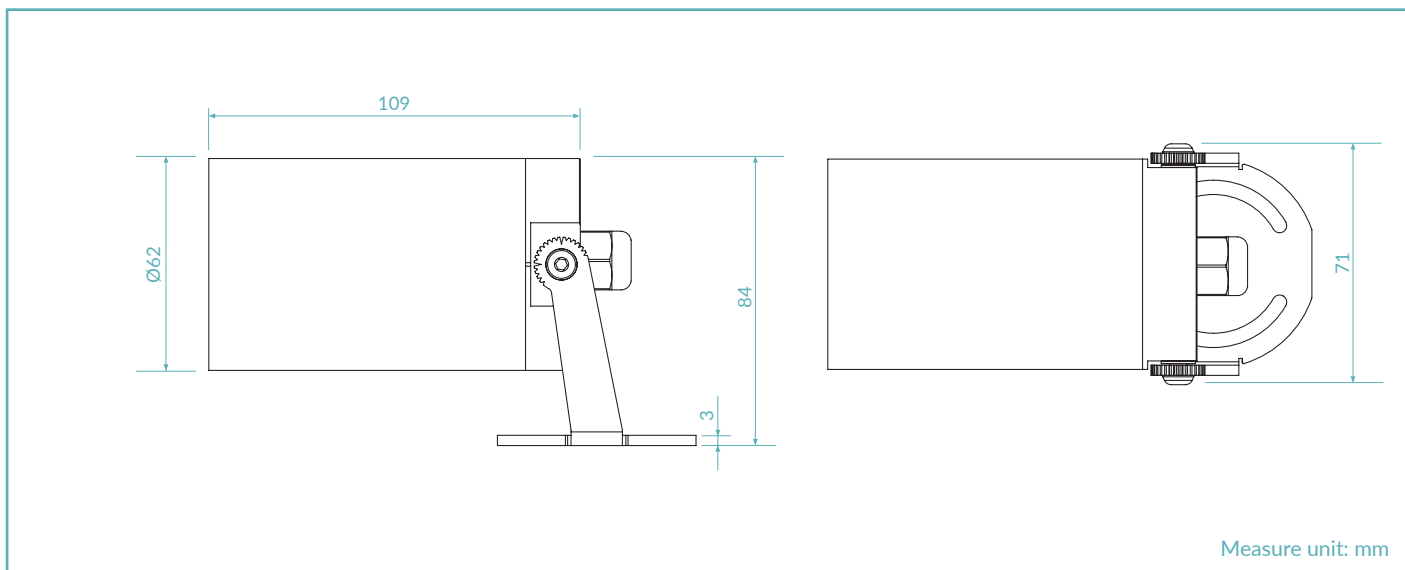

FINISHES

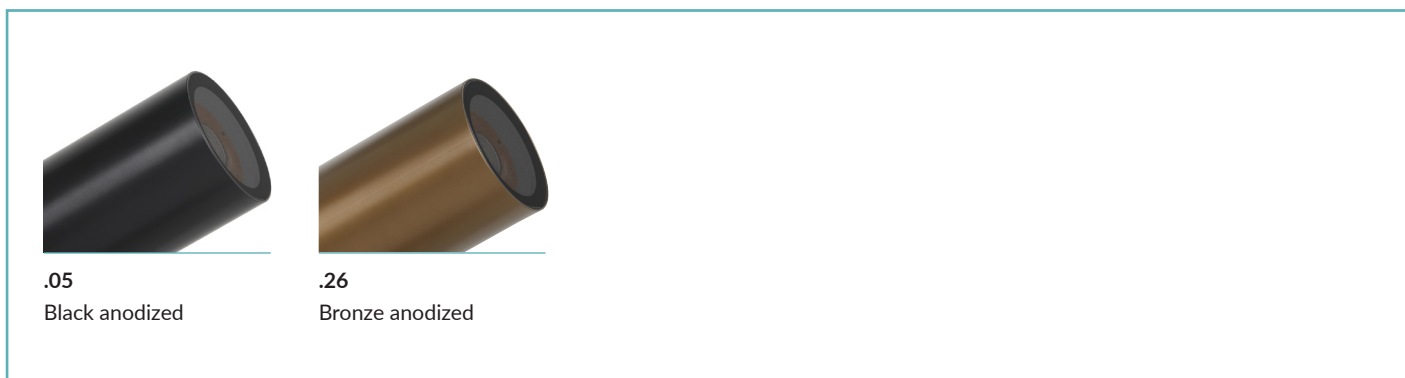

PRODUCT CODE

A6H = AGILE 60	Select one component from each column to specify a complete configuration:			
	LED colour	Optics	Finish	Power
	0	0	05 = Black anodized 26 = Bronze anodized	AC

Standard configuration example:

A6H.0.0.05.AC | Agile 60 black anodized

TECHNICAL SHEET

MECHANICAL CHARACTERISTICS

Body	Anodized aluminium 6026
Glass	Tempered extra clear glass 5mm
Finishes	Black anodized / Bronze anodized
Installation	Surface mounted / Tree strap / Ground spike
Impact resistance	IK08
Weight	450g

ELECTRICAL CHARACTERISTICS

Power supply	120/230Vac 50/60 Hz GU10 Socket
Power supply cables	150cm H05RNF 3x1mm ²
Power consumption	Max 7,5 Watt
Dimmable	Trailing-edge dimmable
Lampholder	GU10

GENERAL CHARACTERISTICS

Operating temperature	-20°C +50°C
IP rating	IP66
Insulation class	Class I

ACCESSORIES

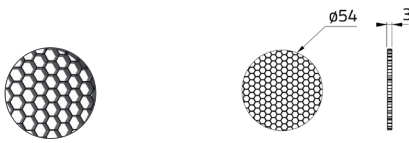

Honeycomb louver

Art. Nr.
ACC.172

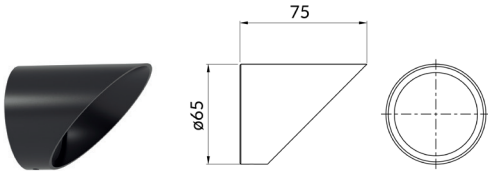

Snoot 45°

Art. Nr.
ACC.012

Finishes
.05 = Black anodized
.26 = Bronze anodized

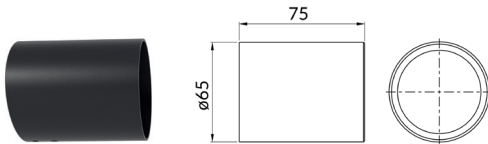

Snoot tube

Art. Nr.
ACC.107

Finishes
.05 = Black anodized
.26 = Bronze anodized



Tree strap

Art. Nr.
ACC.185

Finishes
.05 = Black anodized
.26 = Bronze anodized

Nr. Plates
.01 = Plate
.02 = Plates
.03 = Plates
.04 = Plates

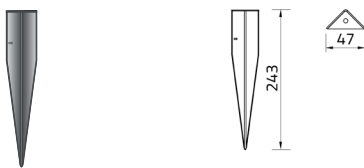

Ground spike

Art. Nr.
ACC.173

Finishes
.03 = Stainless steel AISI316L

Length
.024 = 243mm



Cable gland cover

Art. Nr.
ACC.192

ACCESSORIES

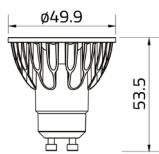

Lamps Soraa	Art. Nr.	LED colour	Optics	Plug	Power
	LMSB	.27 = 2700K .30 = 3000K	.N = 10° .M = 25° .W = 36° .F = 60°	.G10 = GU10	.07 = 7,5W

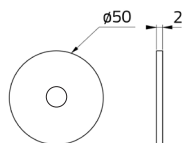
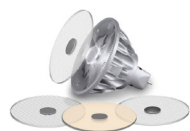

Snap accessories Soraa	Art. Nr.
	ACC.180 = Elliptical optics 10°x60° (*)
	ACC.181 = Orientation of the beam angle (*)
	ACC.182 = CCT Shifter 1/2 (*)
	ACC.183 = CCT Shifter 1/4 (*)
	ACC.184 = CCT Shifter 3/4 (*)

(*Only for 10° optics)

OPTICS

