



IP66



APOLLO CAFFÈ

Apollo Caffè is an elegant, portable and rechargeable lamp. With its diffused optic, it creates an enveloping and warm atmosphere. It offers a choice of three colour temperatures 2400K, 2700K, 3000K and is flicker-free dimmable up to 0.1%.

Apollo Caffè est une lampe élégante, portable et rechargeable. Avec son optique diffuse, il crée une atmosphère enveloppante et chaleureuse. Il offre un choix de trois températures de couleur 2400K, 2700K, 3000K et est dimmable sans scintillement jusqu'à 0,1%.

TECHNICAL DATA / FICHE TECHNIQUE:

 IP66

 2W

 147lm (3000K)

 >90



 2400K / 2700K / 3000K

 Diffused

FINISHES / FINITIONS:

 White RAL 9003
Blanc RAL 9003

 Black RAL 9005
Noir RAL 9005

 Flamed bronze
Bronze flammé

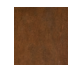
 Corten
Corten

 Deep chromed black
Chromé profond noir

 Bronze anodized
Bronze anodisé

OPTICS / OPTIQUE:

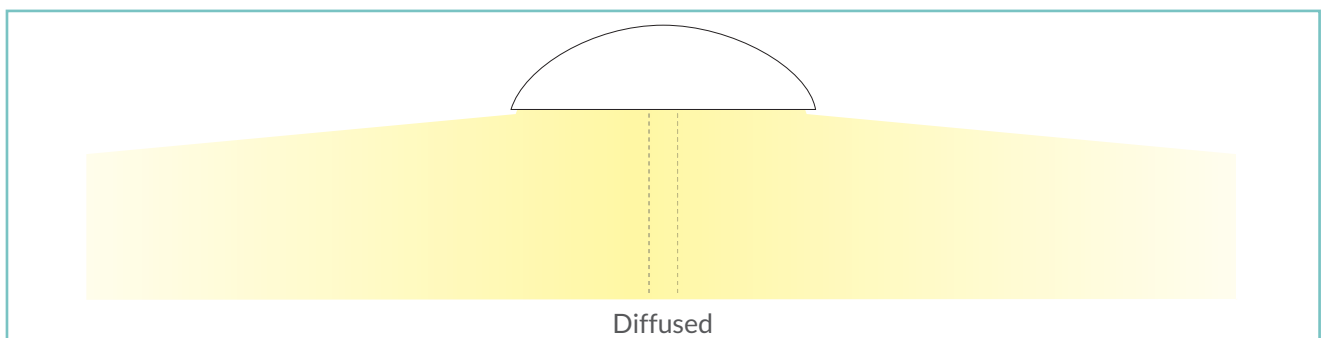

unonovasette



unonovesette

PRODUCT CODE / CODE PRODUIT:

APC = APOLLO CAFFÈ		Select one component from each column to specify a complete configuration: Sélectionner un composant pour chaque colonne pour une configuration complète:		
	LED colour / Couleur LED	Optics / Optique	Finish / Finitions	Power / Puissance
	24 = 2400K 27 = 2700K 30 = 3000K	D = Diffused / Diffuse	01 = White RAL 9003 / Blanc RAL 9003 02 = Black RAL 9005 / Noir RAL 9005 16 = Flamed bronze / Bronze flammé 20 = Corten / Corten 22 = Deep chromed black / Chromé profond noir 26 = Bronze anodized / Bronze anodisé	02 = 2W

Standard configuration example/
Exemple de configuration standard:

APC.30.D.01.02 Apollo Caffè 3000K diffused optics white / Blanc 2W

TECHNICAL DRAWING / DESSIN TECHNIQUE:

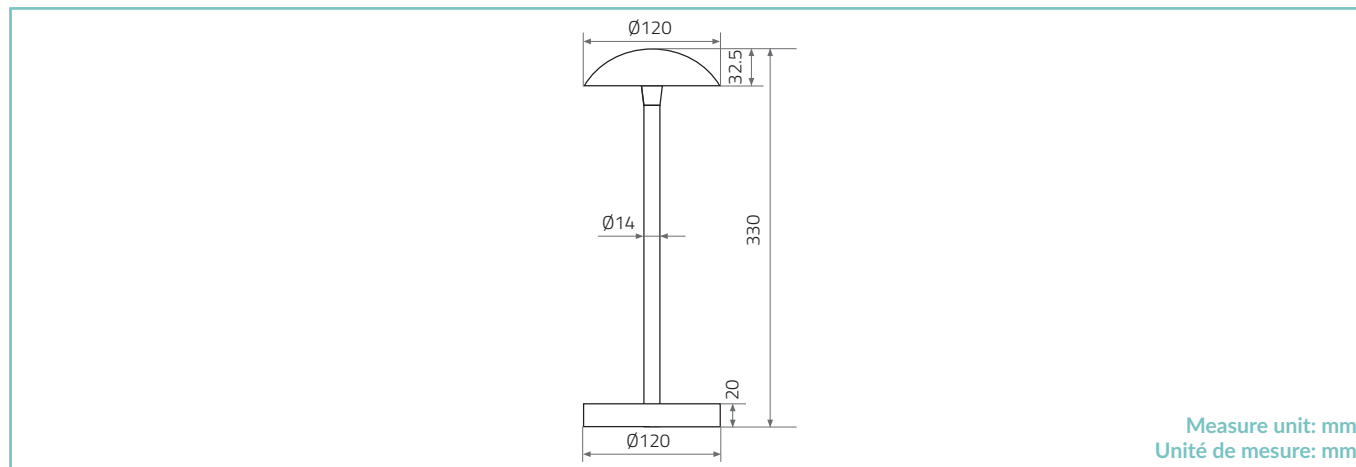

TECHNICAL SHEET / FICHE PRODUIT:

Body:	Aluminium anticorodal 6082	Corps:	Aluminium anticorodal 6082
Finishes:	White RAL 9003 / Black RAL 9005 / Flamed bronze / Corten / Deep chromed black / Bronze anodized	Finitions:	Blanc RAL 9003 / Noir RAL 9005 / Bronze flammé/ Corten / Chromé profond noir / Bronze anodisé
Power supply cables:	USB-C	Câbles d'alimentation:	USB-C
Power supply:	Integrated battery 6000mAh 22.2Wh	Alimentation:	Batterie intégrée 6000mAh 22.2Wh
Power consumption:	2 Watt	Puissance absorbée:	2 Watt
CRI:	>90	IRC (Indice de Rendu des Couleurs)	>90
Bin selection:	Binning free 2 step MacAdam's	Sélection du bin:	Binning free 2 step MacAdam's
Lumen output (source):	147 lm (3000K)	Flux lumineux (source):	147 lm (3000K)
Lumen output (delivered):	103 lm (3000K)	Flux lumineux (sortant):	103 lm (3000K)
Operating temperature:	-20°C +50°C	Température de fonctionnement:	-20°C +50°C
IP rating:	IP66	Indice de protection:	IP66
Insulation class:	Class III	Classe d'isolation:	Classe III
Weight:	910g	Poids:	910g
Optics:	Diffused	Optique:	Diffuse
LED colour temperature:	2400K / 2700K / 3000K	Couleur LED:	2400K / 2700K / 3000K
Lifetime LED:	50000h L95 B10 (Ta 25°C)	Durée moyenne LED:	50000h L95 B10 (Ta 25°C)
Photo biological risk:	RG0	Sécurité photobiologique:	RG0